

greensIRON 6200

BOWLING GREEN ROLLER

OPERATION, SERVICING & PARTS MANUAL



Manufactured Exclusively by



PRESIDENT'S MESSAGE



On behalf of Wood Bay Turf Technologies and your local distributor of our lawn bowling maintenance products, we welcome you as a new *greensIRON 6200* owner. **You are rolling in the right direction.**

Introducing a *greensIRON* into your turf maintenance program will provide many important benefits. Our engineers who designed the latest *greensIRON* were thinking about you. We've met the challenge by working with greens keepers, to smooth their green surfaces for bowls, to increase green speed, to decrease mowing frequency, to repair the playing surface after aeration and/or top dressing and to allow an increase in mowing heights to reduce turf stress.

We urge you to read this manual carefully. The instructions and recommendations outlined will help assure safe and enjoyable use of this equipment.

Thank you for choosing the *greensIRON 6200*.

D. Lyall Adams
President

INTRODUCTION

The purpose of this manual is to provide you with reference information and assistance in setting up, adjusting and operating your *greensIRON 6200* in a safe, effective and efficient manner. It is intended for turf rollers with a hydrostatic transmission. We hope that it will answer most of your immediate questions, but we encourage you to contact Wood Bay Turf Technologies on our toll free telephone line (available in North America at 1-800-661-4942) or the local distributor for further assistance.

The manual alerts you to safety considerations, features of the *greensIRON*, normal operations including ironing techniques, adjustments in speeds, servicing, troubleshooting and provides a replacement parts list.

Please note that the information, illustrations and specifications contained in this manual are based on the latest product information available at the time of printing. Wood Bay Turf Technologies reserves the right to make changes at any time, without notice, in specifications and models and also to discontinue models. The right is also reserved to change any specifications or parts at any time without incurring any obligation to install the same equipment on models manufactured prior to the date of such change.

The illustrations used in this manual may not depict actual models or equipment and are intended as representative views for reference only.

TABLE OF CONTENTS

SECTION	PAGE
1 WARNINGS – SAFETY CONSIDERATIONS	3
2 MAJOR COMPONENT DESCRIPTIONS	4
3 FEATURES.....	5
4 OPERATION	6
BEFORE STARTING	6
STARTING ENGINE	6
PEDAL CONTROL	7
STEERING	7
LOADING/UNLOADING	7
IRONING TECHNIQUES AND PRACTICES	8
5 SERVICING	9
6 TROUBLE SHOOTING	10
7 PARTS LIST AND ILLUSTRATIONS	11
8 WARRANTY.....	27

WARNINGS-SAFETY CONSIDERATIONS

PLEASE OBSERVE ALL WARNING STICKERS ON THE EQUIPMENT.

WARNING INDICATES A STRONG POSSIBILITY THAT EQUIPMENT DAMAGE OR PERSONAL INJURY COULD OCCUR.

- * **WARNING** Do not use your foot, by dragging it on the turf or pushing it against the ditch board or fence as a method of braking or slowing down the *greensIRON*. Never use your foot to push off from the edge of a bowling green.
- * **WARNING** Know how to stop the engine quickly, and understand the operation of all controls. Never permit anyone to operate the *greensIRON* without proper instructions.
- * **WARNING** Do not over fill the fuel tank. There should be no fuel in the filler neck. If any fuel is spilled, clean it up completely and allow petroleum vapor to dissipate before starting the engine. Refuel in a well-ventilated area with the engine stopped; do not smoke or allow a flame or sparks in the area. Gasoline is highly flammable and explosive under certain conditions. Close the filler cap securely.
- * **WARNING** The exhaust muffler becomes very hot during operation and remains hot for a period of time after stopping the engine. Be careful not to come in contact with the exhaust muffler while it is hot.
- * **WARNING** Children or passengers must not be allowed to ride on the unit.
- * **WARNING** Start and stop the engine from a seated position when possible, and ensure both pedals are in the neutral position to avoid unexpected movement.
- * **WARNING** Be aware of the conditions you are operating under. The *greensIRON* may have less traction on wet, or on higher cut turf.
- * **WARNING** Ensure that the engine is shut off and disabled prior to servicing any component under the safety guards, transmission, engine coupler, or the engine itself.
- * **WARNING** Wear suitable protective clothing so as to prevent eye or ear impairment or loss.
- * **WARNING** Sudden release of a clutch pedal on a hydrostatic model will result in a sudden stop of the *greensIRON*.
- * **WARNING** Drive the *greensIRON* up and down ramps carefully on to the bowling green surface; use the trolley to transport *greensIRON* to the edge of the green.
- * **WARNING** Do not operate the *greensIRON* over a plinth board protruding above the surface of the green.
- * **WARNING** Do not operate the *greensIRON* on concrete surfaces.

TO VALIDATE WARRANTY FILL OUT AND RETURN TO WOOD BAY TURF TECHNOLOGIES THE SAFETY ACKNOWLEDGEMENT AND WARRANTY FORMS (see Page 21).

SECTION 2

MAJOR COMPONENT DESCRIPTIONS

FRONT

- 1** Throttle Control (on mechanical transmission units only) c/w Soft Hand Grip
- 2** Steering System (handle bar adjustment lever)
- 3** Honda GX160 HX 5.5 hp Engine
- 4** Manual Recoil Starter
- 5** Engine Switch (ON/OFF) & Oil Alert
- 6** Steering Rollers
- 7** Drive Roller (Super Track Vulcanized Coating)

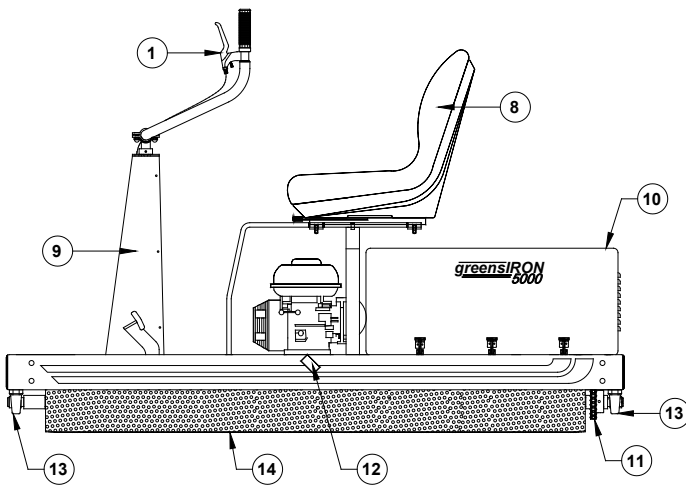
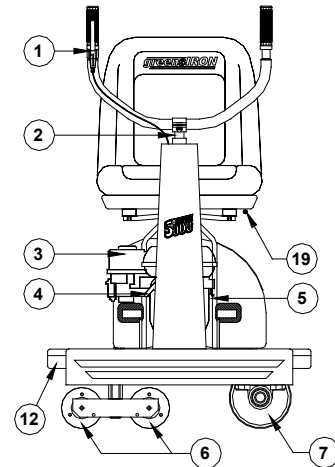

SIDE

- 8** High Back Adjustable Seat c/w Drain Hole
- 9** Steering Column Cowling and Cover
- 10** Transmission Cover
- 11** Drive Chain and Sprocket
- 12** Trolley Lifting Lug
- 13** Drive Roller Bearing
- 14** Super Track (disperses water)

TOP

- 15** Aluminum Non Slip SafetyDeck Surface
- 16** Right Direction Pedal
- 17** Left Direction Pedal
- 18** Seat Adjustment Lever

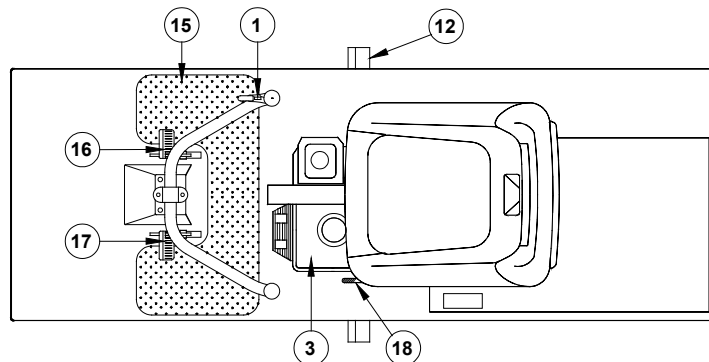

SECTION 3

FEATURES

- ◆ Engineered for ease of operation from start to finish.
- ◆ Unique steering system allows operator to maneuver with ease across green.
- ◆ High back padded seat with slide adjustment for maximum operator comfort and back support.
- ◆ Handle bar adjustment lever for increased operator steering control.
- ◆ Low maintenance hydrostatic transmission and hydraulic motor.
- ◆ Machined and tapered high carbon steel steering rollers give maximum durability and beautiful manicured bowling greens.
- ◆ Super Trac vulcanized covered drive roller provides excellent traction and produces a soft touch effect to turf surfaces and bowl roll.
- ◆ Industrial bearings, with easy access to grease ports.
- ◆ Honda GX160 HX 5.5 hp engine with oil alert.
- ◆ greensIRON trolley for transporting the roller from the storage building to the edge of the green.
- ◆ Easy access to hydrostatic transmission and drive chain adjustments.
- ◆ Oil drain hose for convenient servicing of Honda motor.
- ◆ Tiny Tach hour / RPM meter to assist in maintaining accurate maintenance schedules.
- ◆ **Three year warranty on parts and labor – “Best in the Industry”.**
- ◆ **ENGINEERED FOR DURABILITY; BUILT TO LAST!**

Having a greensIRON 6200 is rolling in the right direction!

OPERATION

BEFORE STARTING YOUR *greensIRON* 6200 TURF ROLLER

- ✓ Refer to your Honda engine, and Hydro-Gear hydrostatic pump owner's manuals for startup and break-in recommendations.
- ✓ Check oil level in engine and transmission reservoir (oil tank).
- ✓ Check oil type and level in hydrostatic transmission reservoir sight glass and ensure that the fluid is not discolored and that only Mobil 1 Synthetic 15/30 SAE oil is used.
- ✓ Check fuel level (unleaded fuel is recommended).
- ✓ Check drive chain adjustment. Chain may require adjustment (eg., tightening) after initial use.
- ✓ Check on both sides of the *greensIRON* to ensure there are no obstructions (eg., gravel/stones) that could impact on the roller covering.

STARTING ENGINE

- ✓ Turn the fuel switch to the ON position.
- ✓ Turn the engine switch to the ON position.
- ✓ Engage the choke switch if required.
- ✓ Pull the starter recoil handle (it is recommended that the operator start the engine while seated on the *greensIRON*). Keep feet off foot pedals.
- ✓ Once the engine is running, shut off the choke switch and adjust the throttle speed.
- ✓ Set the throttle speed with the manual throttle lever located on the engine.
- ✓ To shut down the engine, switch motor to OFF position, and shut OFF the fuel switch.

- 1 Fuel switch
- 2 Choke
- 3 Manual throttle lever
- 4 Engine switch
- 5 Pull start handle

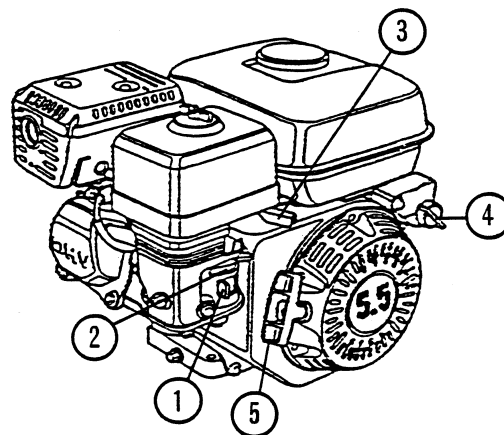

PEDAL CONTROL

- Depress the foot pedal for desired direction of travel; left pedal for left travel; right pedal for right travel. For increased speed, press the pedal down further.
- When stopping, ease back on the foot pedal. **CAUTION:** Sudden foot pedal release will result in an **IMMEDIATE** stop, which could bruise the green. When both pedals are in neutral, the roller will not move.
- Do not “jam” a foot pedal down quickly to start the turf roller in motion. This will cause the drive roller to abruptly start and potentially “burn” the turf.

STEERING

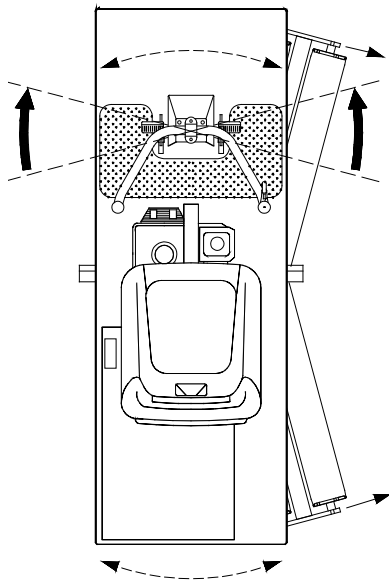

Pushing the left handle bar away from the operator will pivot the front of the steering rollers away from the deck. This will cause the *greensIRON* to commence a turn to the right when rolling in that direction, or to the left when moving in the opposite direction.

Pushing the right handle bar away from the operator will pivot the back of the steering rollers away from the deck. This will cause the *greensIRON* to commence a turn to the left when rolling to the right, or to the right when rolling to the left.

Avoid over steering to prevent the possibility of bruising the turf. Always have the *greensIRON 6200* in motion when undertaking turning maneuvers to prevent unnecessary turf damage (bruising the grass).

LOADING AND UNLOADING

- To transport the *greensIRON 6200*, hook the trolley arms under the trolley lift lugs located on both sides of the deck and press downward on the trolley handlebars to raise the *greensIRON* off the ground. Maneuver in the direction desired.
- Avoid taking the trolley on to a bowling green surface as the tires may damage the turf surface. If the trolley must be taken on to the bowling green, avoid making sharp turns.
- Ensure the transport trolley is removed away from the *greensIRON* before starting up the engine.
- Ideally, to eliminate the need for taking the trolley on to a bowling green, the operator should use a shallow sloping ramp suitably fixed to the back boards and then carefully drive the *greensIRON 6200* on to and off the playing surface.

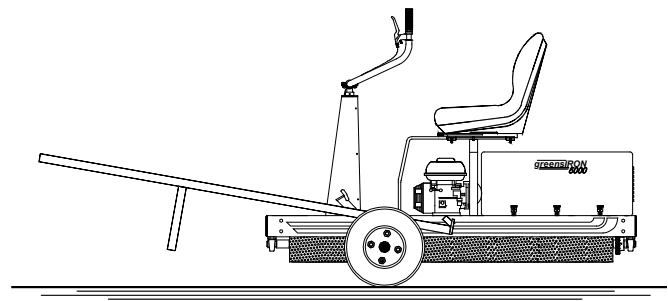

IRONING TECHNIQUES & PRACTICES

- The most efficient rolling pattern requires the operator to make the first pass straight up the bowling green along one edge of the plinth board, then return on the second pass at a slight angle with the front end of the roller coming to the place where the back end of the roller had previously been at the start of the first pass. This procedure should then be repeated until the entire green has been rolled in this fashion.
- A recommended practice is to alter the rolling pattern from one day to the next so that the rolling paths cross over each other (i.e., if the pattern was run longitudinally on the green one time, it should be run laterally on the green the next time). Roll the green in the opposite direction of play.
- When operating on turf that is wet, accelerate with caution to avoid spinning the drive roller and damaging the turf.
- Optimum rolling effect will be obtained at a rolling speed of about 1,000 square feet per minute (3 to 5 MPH).
- Always have the *greensIRON* in motion when undertaking turning maneuvers (not stationary).
- **DO NOT REFUEL THE *greensIRON* WHILE ON THE GREEN SURFACE.**
- **DO NOT TAKE THE TROLLEY ON TO THE PLAYING SURFACE IF AT ALL POSSIBLE.**
- **DO NOT LEAVE THE *greensIRON* SITTING ON THE TURF FOR AN EXTENDED PERIOD OF TIME (rollers will leave marks).**

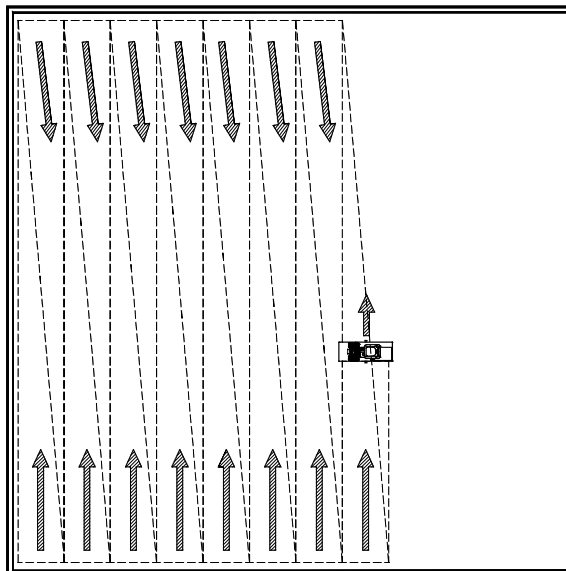

SECTION 5

SERVICING

PRIOR TO SERVICING YOUR *greensIRON 6200*, SHUT OFF ENGINE.

CAUTION: GASOLINE AND OIL SPILLED OR TRACKED ON TO TURF SURFACE MAY CAUSE SEVERE DAMAGE.

ENGINE AND CRANKCASE

- Refer to your Honda owner's manual.

TRANSMISSION

- Refer to your Hydro-Gear hydrostatic transmission owner's manual.

DRIVE CHAIN ADJUSTMENT

- **WARNING:** Before opening transmission cover, ensure engine is shut off.
- The idler sprocket can be adjusted in the direction needed to increase or reduce the chain tension. The chain should have a 3/8" to 1/2" deflection on the bottom under normal operating conditions.
- If it is no longer possible to tighten the chain as needed, remove a half link or a full link to shorten the chain.

THROTTLE LEVER (on the Honda Engine)

- Check that the lever remains in the chosen speed position when set, and tighten setting if needed.

GREASE FITTINGS

- All bearings have been pre-packed with grease. If necessary, bearings should only be greased sparingly.

STEERING ROLLERS AND HANDLE BARS

- Check periodically the steering roller/handle bar lever for correct alignment.
- Steering rollers must be aligned parallel with the right deck edge. The handle bar in neutral or driving position must be at right angles (90°) to the steering rollers. The handle bar alignment can be adjusted by increasing or decreasing the length of the steering rod arm connector assembly under the deck. Making an adjustment requires disconnecting of at least one rod end, releasing the jam nut, and turning the rod end toward or away from the other rod end on the connector assembly.

ROLLERS

- Inspect the rollers for any dirt or grass clippings and clean them prior to operating the unit on the green.

TROUBLE SHOOTING

TROUBLE SHOOTING SUGGESTIONS		
SYMPTOM	PROBABLE CAUSE	SOLUTION
Engine runs rough.	Choke on. Dirty air filter. Intermittent spark. Improper fuel mixture.	Switch off. Clean or replace. Clean or replace spark plug. Readjust—see engine manual.
Engine cuts out when changing throttle speed.	Oil level low. Fuel level low.	Fill to correct level—see engine manual. Fill fuel tank.
No movement left or right when pedals are depressed.	Chain is broken.	Replace chain. Adjust as explained in Section 5.
Jerky motion or chain is jumping.	Not enough tension in chain.	Adjust chain tension as explained in Section 5.
Pedal movement is either too free or is difficult to depress.	Tension on nylock nuts for the linkage arms may need adjustment.	Adjust tension on nylock nuts until a comfortable pedal motion is obtained.
Rattling, grinding type of noise from under deck when turf roller is moving.	Chain may be loose. A steering or drive roller bearing may be failing. Bolts may be loose on moving parts.	If chain is rubbing, ensure it is tightened and properly aligned. Tip roller deck on edge and hand turn rollers to check for noise; grease and/or replace bearings as needed Check and tighten bolts as needed on: <ul style="list-style-type: none"> • Drive roller pillow blocks • Pedal linkages • Steering roller end bolts / housings • Stopper bolts on top of steering frame
Roller continues travelling after release of foot pedals to the neutral position.	Foot pedal return springs require adjusting under the deck.	See transmission manual and Section 9
Transmission is running extra hot, shortly after start up.	Fluid has lost its viscosity (oil has become dark in color), or the wrong type or transmission fluid has been used.	Drain the fluid from the hydrostatic pump and fill with Mobil 1 Synthetic 15W50 SAE oil.

SECTION 7

PARTS LIST AND ILLUSTRATIONS

Trolley Components – Section J

ITEM DESCRIPTION	QUANTITY	PART NUMBER
1. Trolley Frame Assembly	1	50 N72 190
2. Wheel and Hub Assembly	1	50 N79 194
3. Rest for Trolley	2	

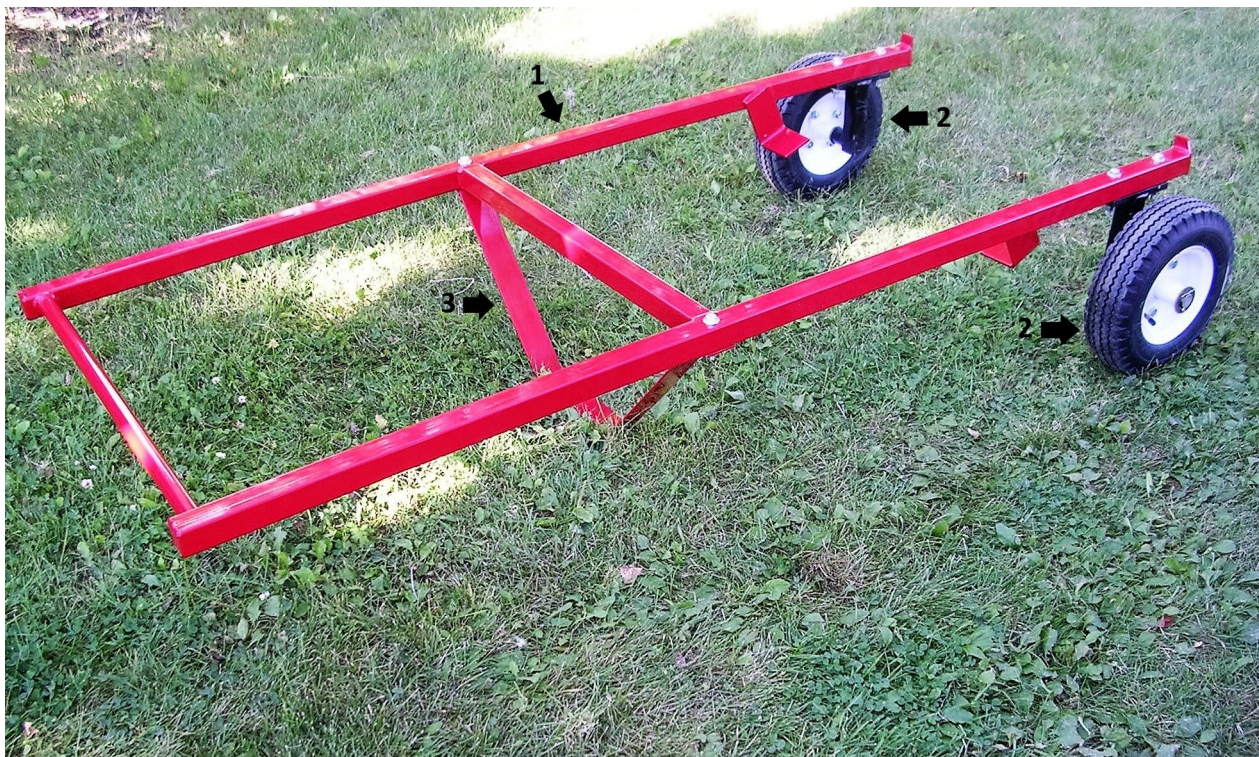

SECTION 7 (con't)

Clutch Components - Section K

Item	Description	Quantity	Part #
1	Clutch Pedal: Left	1	39 K01 101
2.	Clutch Pedal: Right	1	39 K01 102
3.	Key (3/16" x 1 1/4")	1	39 Y02 187
4.	Transmission Rocker Arm	1	39 K01 105
5.	Foot Pedal Linkage	2	39 K01 104
6.	Clutch Pedal Bushing	2	39 K01 103
7.	Bearing and Housing (2 hole: 5/8")	2	39 K02 108
8.	Carriage Bolt (5/16" x 1")	2	39 Z02 208
9.	Flat Washer (5/16")	2	39 Z02 203
10.	Lock Washer (5/16")	2	39 Z02 204
11.	Nut (5/16") NC	2	39 Z02 205
12.	Rod End (3/8" NF: Female RH)	2	39 Y02 183
13.	Jam Nut (3/8" NF RH)	2	39 Y02 185
14.	Rod End (3/8" NF: Female LH)	2	39 Y02 184
15.	Jam Nut (3/8" NF LH)	2	39 Y02 186
16.	Bolt (3/8" x 1 1/4" NC)	4	39 Z02 194
17.	Lock Washer (3/8")	4	39 Z02 196
18.	Nut (3/8" NC)	4	39 Z02 197

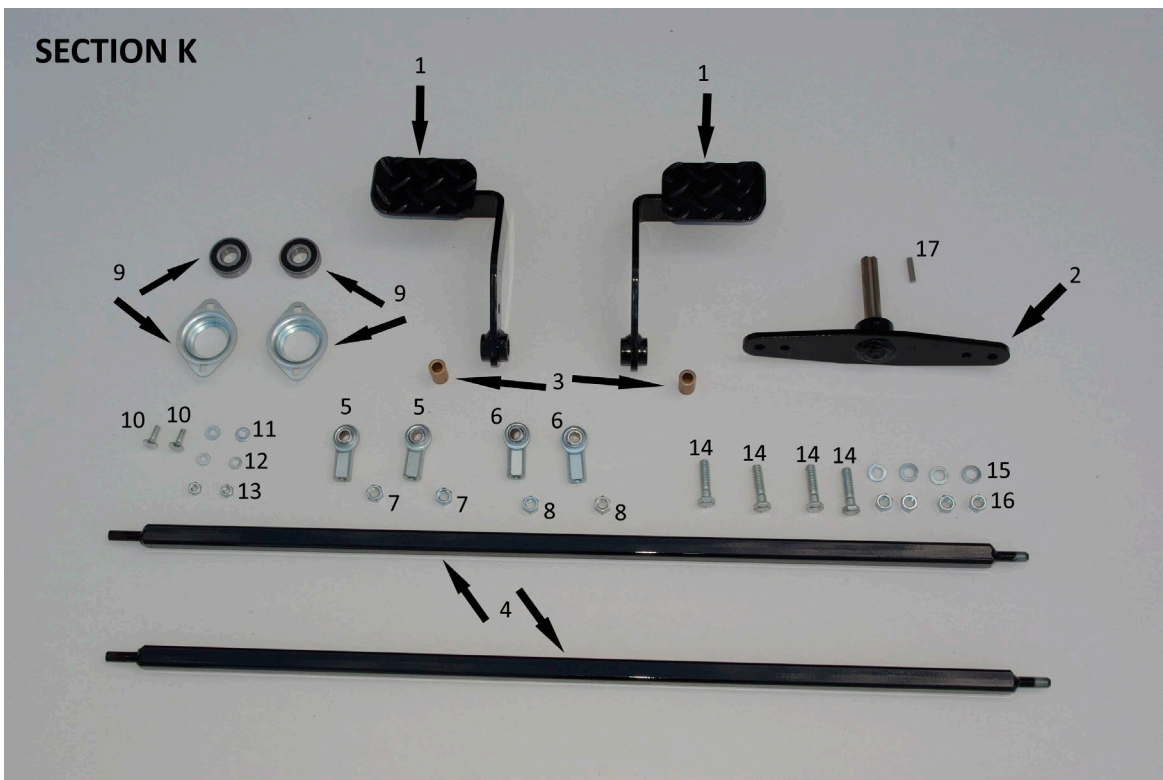

SECTION 7 (con't)

Body Components - Section O

Item	Description	Quantity	Part #
1.	Decal Package: Caution	1 set	39 O01 111
2.	Decal Package: Identification	1 set	39 O01 112
3.	Decal Package: Striping	1 set	39 O01 113
4.	Serial Number Plate	1	39 O01 110
5.	Deck (not shown)	1	39 O01 109

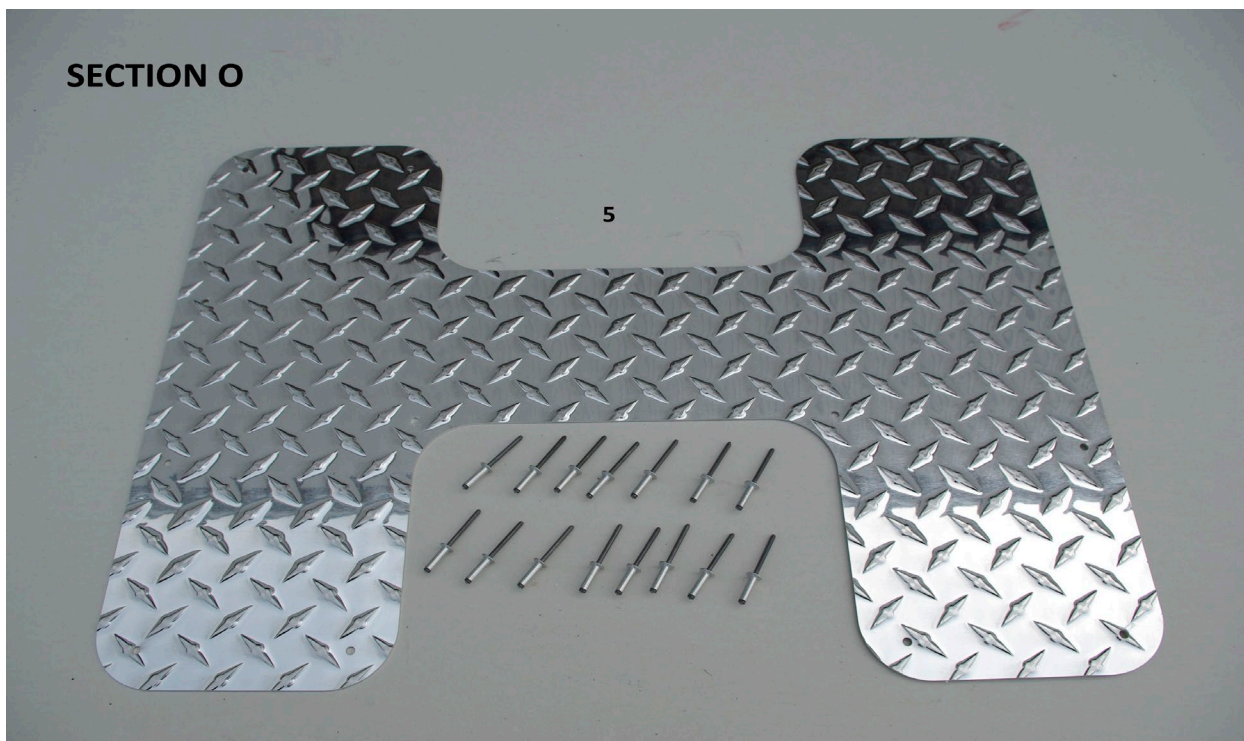

SECTION O

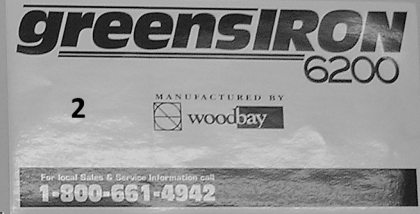

1 **CAUTION**
BE ALERT
MOVING PARTS



1 **CAUTION**
STOP MACHINE
BEFORE MAKING
ADJUSTMENTS

2 *Super Turf Trac System*

2 *Super Turf Trac System*

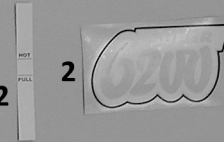

SECTION 7 (con't)

Steering Column Components - Section P

Item	Description	Quantity	Part #
1.	Handle Bar	1	39 P01 118
2.	Steering Hand Grip	2	39 P02 119
3.	Steering Shaft	1	39 P01 120
4.	Handle Bar Clamp	1	39 P01 121
5.	Handle Bar Adjustment Lever	1	39 P02 122
6.	Steering Arm for Under Deck (welded)	1	39 P01 123
7.	Steering Rod Arm (3/8" x 4 1/4" NF)	1	39 P01 124
8.	Rod End (3/8" Female NF)	2	39 Y02 183
9.	Jam Nut (3/8" NF)	1	39 Y02 185
10.	Bearing and Housing (4-bolt 1.0")	1	39 P02 125
11.	Bearing and Housing (2-bolt 1.0")	1	39 P02 126
12.	Bolt (5 1/6" x 1" Allen Head)	1	39 P02 127
13.	Bolt (3/8" x 1 1/2" NC)	4	39 Z02 194
14.	Lock Washer (3/8")	7	39 Z02 196
15.	Nut (3/8" NC)	6	39 Z02 197
16.	Flat Washer (3/8")	1	39 Z02 195
17.	Carriage Bolt (3/8" x 1 1/2" NC)	2	39 Z02 198

SECTION P

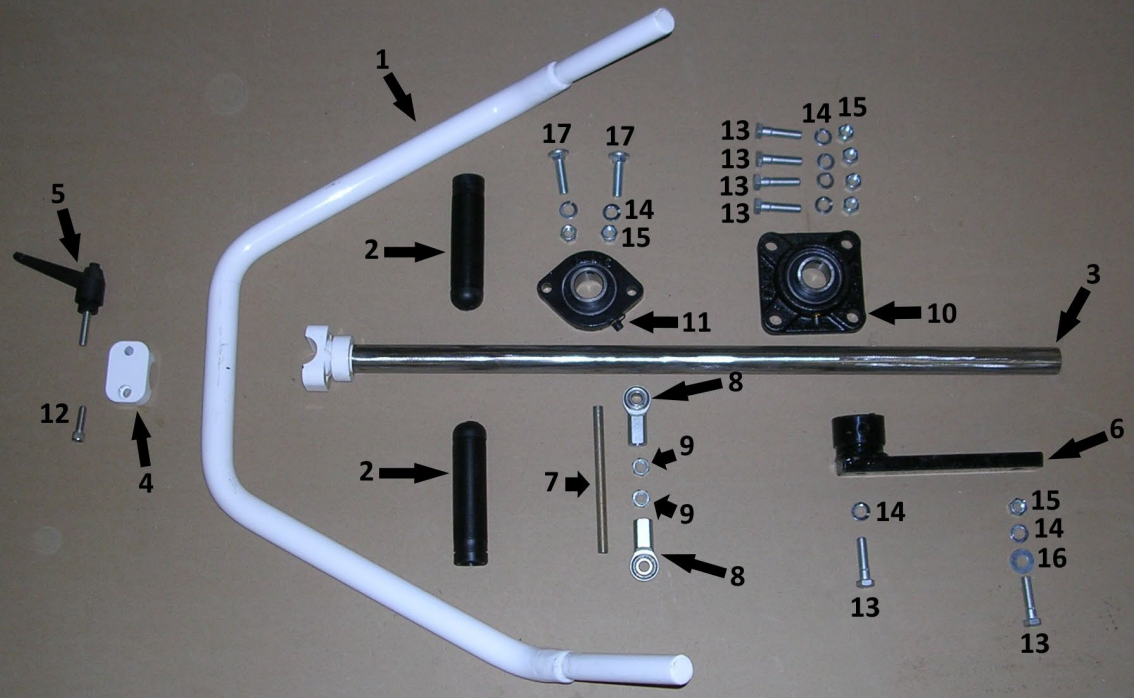

SECTION 7 (con't)

Steering Roller Components - Section Q

Item	Description	Quantity	Part #
1.	Steering Roller Frame	1	39 Q01 128
2.	Steering Roller	2	39 Q01 129
3.	Stub Axle	4	39 Q01 130
4.	Steering Roller Bearing Plate Spacer	1	39 Q01 131
5.	Flange and Bearing (4-bolt c/w 1" Bearing)	1	39 Q02 132
6.	Bearing (1" c/w set screw collar)	4	39 Q02 133
7.	Pressed Flange (3-bolt)	8	39 Q02 134
8.	Snap Ring (1")	1	39 Q02 135
9.	Bolt (3/8" x 1 1/2" NC)	4	39 Z02 193
10.	Flat Washer (3/8")	8	39 Z02 195
11.	Lock Washer (3/8")	8	39 Z02 196
12.	Nut (3/8" NC)	4	39 Z02 197
13.	Bolt (5/16" x 3/4" NC)	12	39 Z02 202
14.	Flat Washer (5/16")	12	39 Z02 203
15.	Lock Washer (5/16")	12	39 Z02 204
16.	Carriage Bolt (3/8" x 1 1/2" NC)	4	39 Z02 198

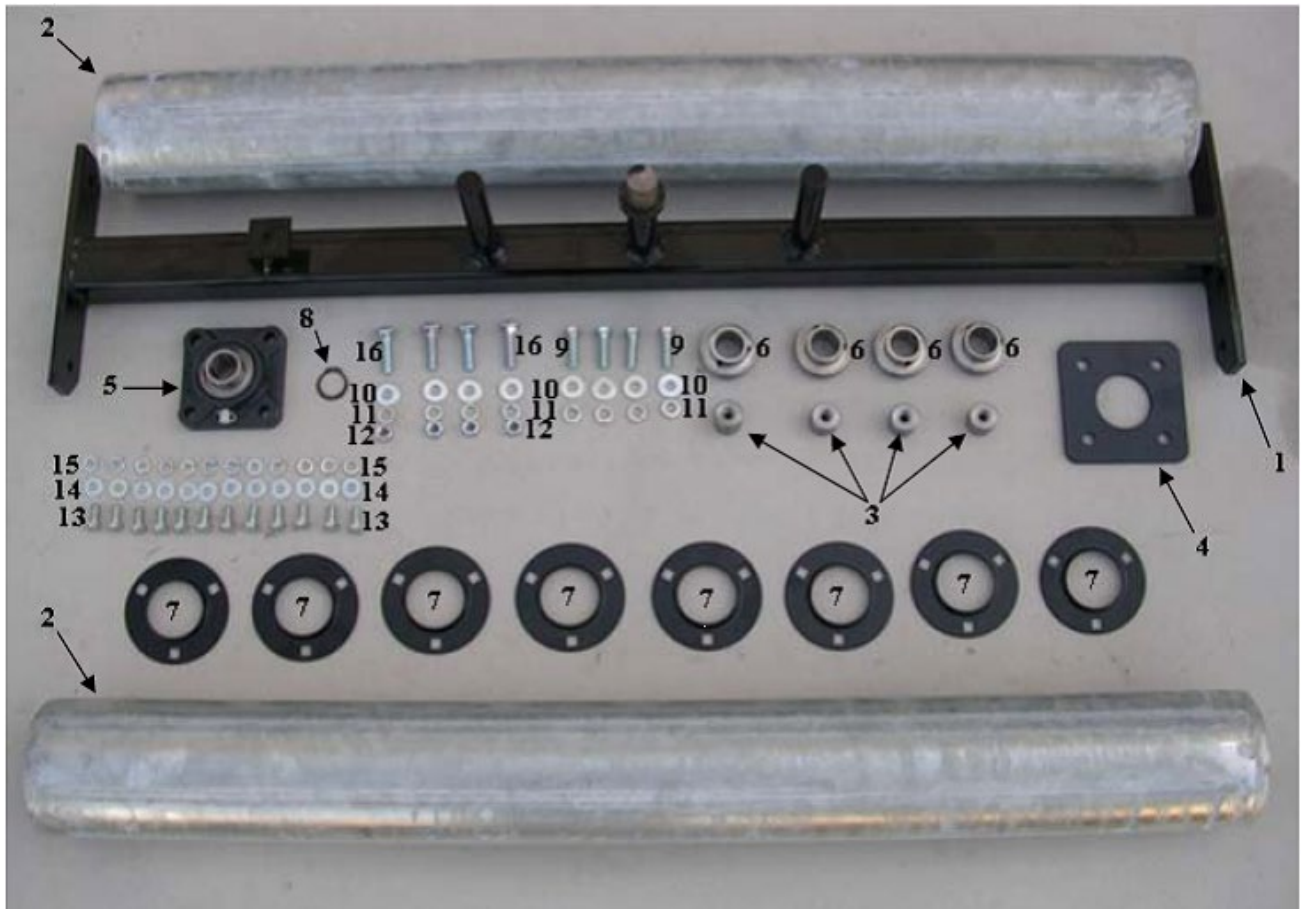

SECTION 7 (con't)

Engine Components - Section R

Item	Description	Quantity	Part #
1.	Honda 5.5 hp with Oil Alert	1	39 R02 136
2.	Motor Vibration Mount	1	39 R02 137
3.	Vibration Dampner	4	39 R02 138
4.	Tiny Tach Hour/RPM Meter	1	39 R02 139
5.	Muffler Deflector	1	39 R02 140
6.	Oil Drain Assembly	1	39 R02 141
7.	Bolt (5/16" x 1 1/2" NC)	4	39 Z02 200
8.	Flat Washer (5/16" NC)	8	39 Z02 203
9.	Lock Washer (5/16" NC)	8	39 Z02 204
10.	Nut (5/16" NC)	8	39 Z02 206
11.	Self Drilling Screw (6" x 1/2")	6	39 R02 142
12.	Carriage Bolt (5/16" x 5/8" NC)	4	39 Z02 209

SECTION R

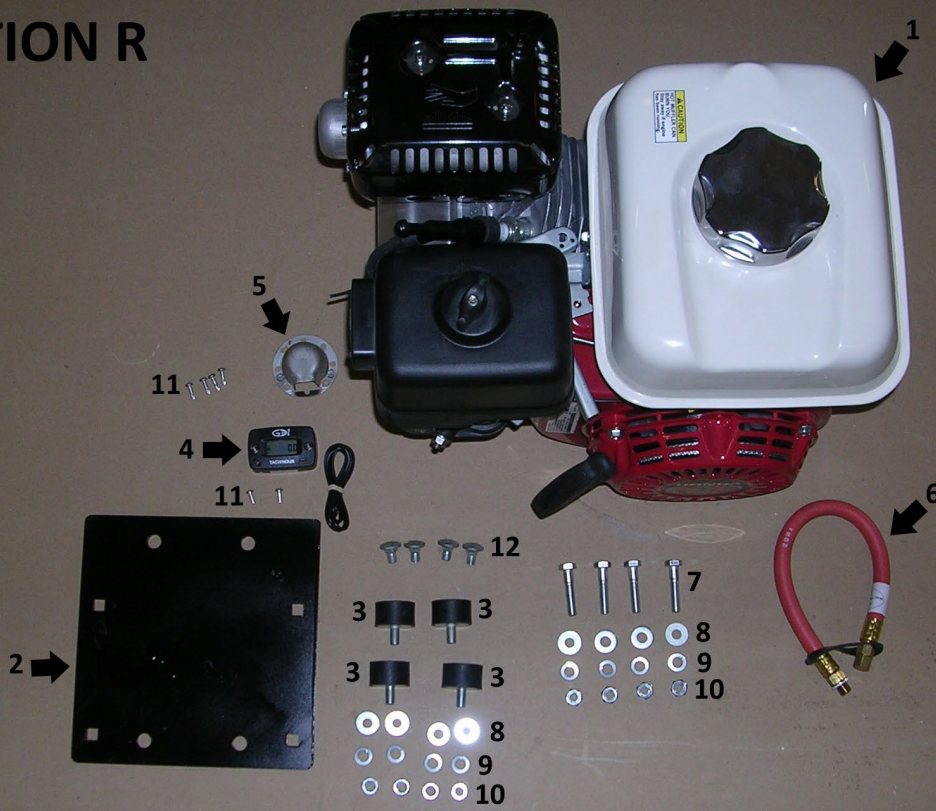

SECTION 7 (con't)**Transmission Components - Section S**

Item	Description	Quantity	Part #
1.	Reservoir (oil tank)	1	39 S01 151
2.	Hydro-Gear 10 cc Piston Pump	1	39 S02 148
3.	ORB Adaptor (hydrostatic transmission to pressure hose)	2	39 S02 165
4.	Hydrostatic Transmission Mounting Bracket	1	39 S01 147
5.	Reservoir Breather Cap	1	39 S02 152
6.	90 degree Bent Stern 1/2" Fitting	5	39 S02 156
7.	60 degree Bent Stern 1/2" Fitting	1	39 S02 157
8.	Hose Clamp (to fit 1/2" suction hose)	6	39 S02 158
9.	Return Hose (1/2" x 12.0")	1	39 S02 162
10.	Suction Hose (1/2" x 6.0")	1	39 S02 160
11.	Suction Hose (1/2" x 4.0")	1	39 S02 161
12.	Pressure Hose (1/2" x 10.0")	1	
13.	Pressure Hose (1/2" x 10.0")	1	
14.	Filter (25 micron)	1	39 S02 155
15.	Sight Glass	1	39 S02 153
16.	Filter head	1	39 S02 154
17.	Hydraulic Motor c/w woodruff key (1/4" x 1.0")	1	39 S02 150
18.	ORB Adaptor (hydraulic motor to pressure hose)	2	39 S02 164
19.	Engagement Arm	1	39 S01 168
20.	Bolt (1/4" x 1/2" Grade 8)	2	
21.	Coupling Insert (spider)	1	35H016680
22.	Coupler (for spider) 5/8"	1	35H016670
23.	Coupler (for spider) 3/4"	1	35H016660
24.	Woodruff Key (1/4" x 1.0")	1	39 S02 173
25.	Drain Plug (1/2")	1	39 S02 165
26.	Transmission Engagement Rod (5/16" x 5.0" NF)	1	39 S01 169
27.	Rod End (5/16" – Female RH)	2	39 S02 170
28.	Jam Nut (5/16" NF)	2	39 Z02 207
29.	Bolt (3/8" x 1 1/2" NC)	2	39 Z02 193
30.	Flat Washer (3/8")	10	39 Z02 195
31.	Lock Washer (3/8")	6	39 Z02 196
32.	Nut (3/8") NC	8	39 Z02 197
33.	Carriage Bolt (3/8" x 1 1/4") NC	2	39 Z02 199
34.	Bolt (3/8" x 1 1/2" NC)	2	39 Z02 192
35.	Nut (metric #8)	2	39 Z02 213
36.	AVM Dampner	1	39 S02 171
37.	Carriage Bolt (3/8" x 1") Grade 8	2	39 S02 173
38.	Bolt (5/16" x 1") NC	3	39 Z02 201
39.	Flat Washer (5/16")	3	39 Z02 203

40.	Lock Washer (5/16")	3	39 Z02 204
41.	Nut (5/16") NC	3	39 Z02 206
42.	Bolt (1/4" x 3/4"NC)	2	39 Z02 210
43.	Flat Washer (1/4")	2	39 Z02 211
44.	Lock Washer (1/4")	2	39 Z02 212
45.	Key 3/16" x 1 1/4"	1	39 Y02 187
46.	Hydraulic Motor Mount	1	39 S01 149

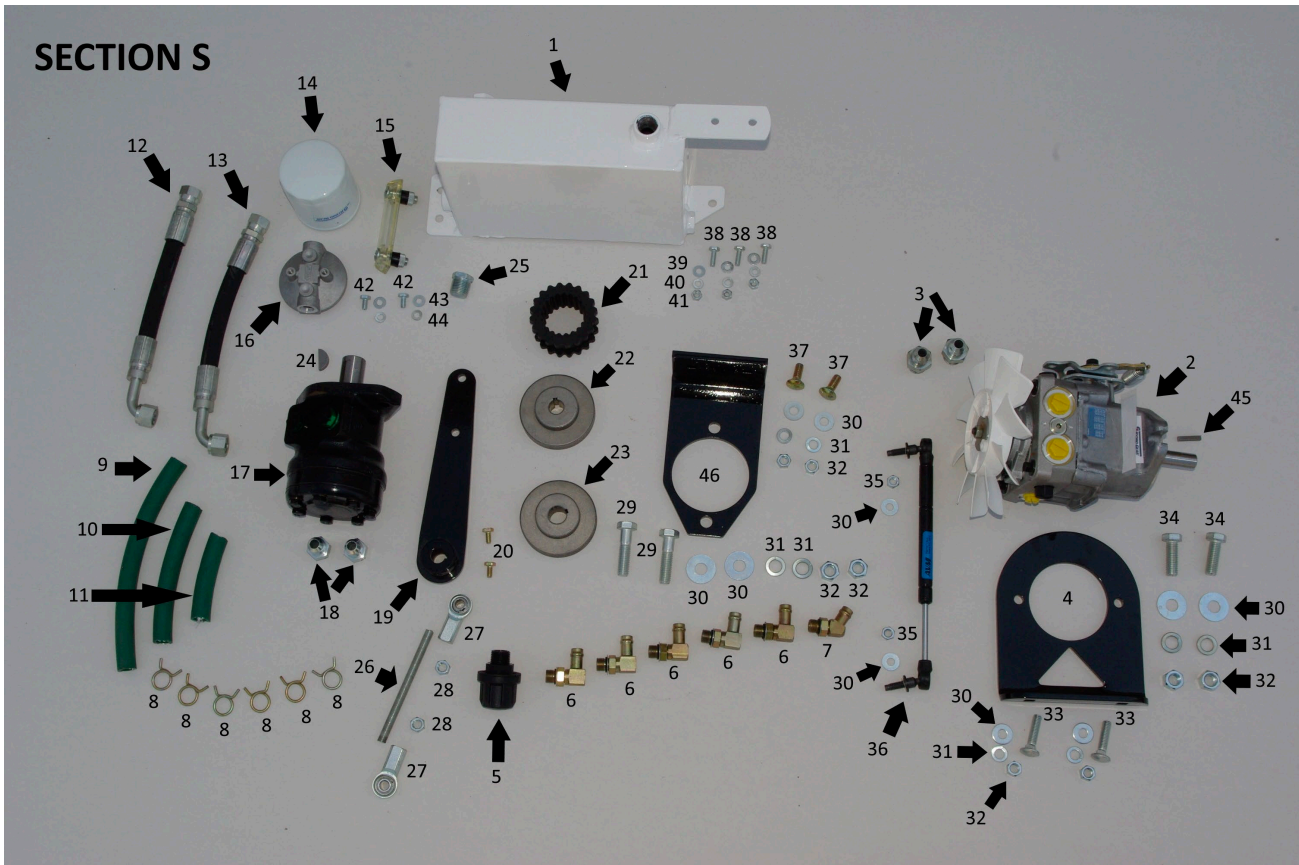

SECTION 7 (con't)

Main Drive Components - Section W

Item	Description	Quantity	Part #
1.	Transmission Sprocket (#50 23T - 1.0" Bore)	1	39 W02 173
2.	Drive Chain (#50 39")	1	39 W02 174
3.	Drive Chain Connector #50	1	39 W02 175
4.	Idler Sprocket (#50 13T 1/2" Bore)	1	39 W02 176
5.	Chain Adjuster Bracket	1	39 W01 177
6.	Bolt (1/2" x 2.5" NC)	1	39 Z02 188
7.	Flat Washer (1/2")	3	39 Z02 190
8.	Lock Washer (1/2")	2	39 Z02 191
9.	Nut (1/2" NC)	1	39 Z02 192
10.	Carriage Bolt (3/8" x 1 1/4" NC)	2	39 Z02 199
11.	Flat Washer (3/8")	2	39 Z02 195
12.	Lock Washer (3/8")	2	39 Z02 196
13.	Nut (3/8" NC)	2	39 Z02 197

SECTION W

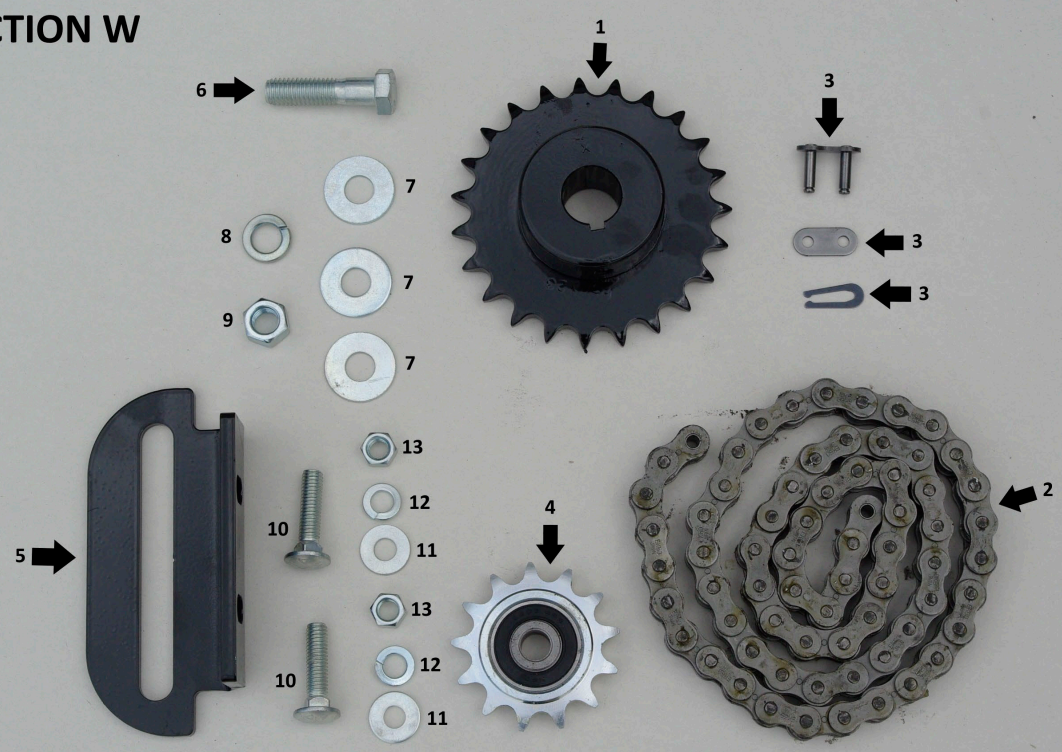

SECTION 7 (con't)

Drive Roller Components - Section X

Item	Description	Quantity	Part #
1.	Drive Roller	1	62 X01 371
2.	Sprocket (#50 23T)	1	39 X02 180
3.	Bearing and Housing (2-bolt PB 1.0")	2	39 X02 181
4.	Key (1/4" x 1/4" x 1 1/4")	1	39 X02 182
5.	Bolt (3/8" x 1 1/2" NC)	4	39 Z02 193
6.	Flat Washer (3/8")	8	39 Z02 195
7.	Lock Washer (3/8")	4	39 Z02 196
8.	Nut (3/8" NC)	4	39 Z02 197

SECTION X

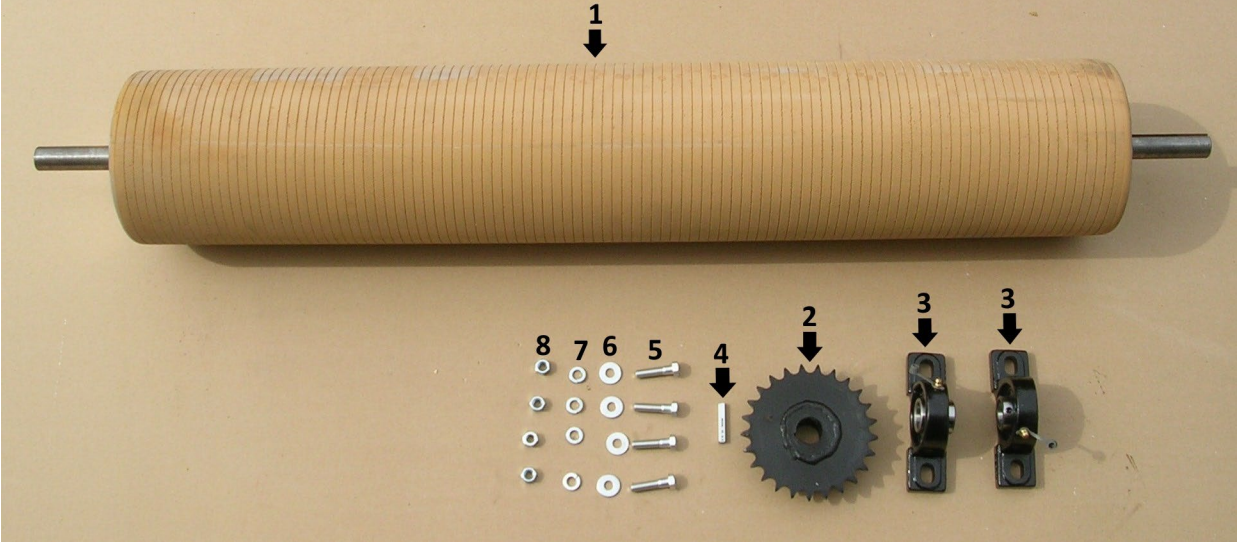

Warranty

greensIRON 6200 TURF ROLLERS

WARRANTY is provided as part of Wood Bay's support program for customers who operate and maintain their equipment as described in this manual and other enclosed owner's manuals.

This warranty provides you with the assurance that Wood Bay will back this product where defects appear within the warranty period. Should the product be abused or modified to change its performance from original factory specifications, the warranty will become void.

If you have any questions.....

Wood Bay distributors are very interested in your complete satisfaction with the performance of your *greensIRON 6200*. In the event of a warranty or related servicing matter, we encourage you to contact your local distributor as soon as possible. Should the warranty or servicing problem not be resolved to your satisfaction, submit the matter to:

Wood Bay Turf Technologies

Toll free: 1-800-661-4942 (USA, Canada)

1-780-468-4378 (USA, Canada)

011-1-780-468-4378 (International)

E-mail: info@woodbayturftech.com

Website: www.woodbayturftech.com

SECTION 8 (con't)

A. GENERAL PROVISIONS

For the first thirty-six (36) months after the date of purchase, the manufacturer will repair or replace, as it elects, any part(s) defective in material or workmanship (except those specified in Sections B and C below) of a new **greensIRON 6200** Turf Roller and Trolley (the "Product"), as delivered to the original retail purchaser. This warranty applies only to purchases from authorized distributors and extends only to the original retail purchaser of the product.

The performance of this warranty is dependant on receipt by Wood Bay Turf Technologies or Wood Bay Consulting Group Limited (hereinafter referred to as the "manufacturer") of the warranty registration card from the original retail purchaser.

B. ITEMS WARRANTED SEPARATELY

This warranty does not apply to the Honda engine or to the Hydro-Gear hydrostatic pump, which are covered by separate warranty.

C. ITEMS NOT COVERED

The manufacturer is not responsible for the following:

1. Premium charged for overtime labor requested by the purchaser.
2. Transportation to and from the distributor's office or service calls made by the distributor.
3. Used products.
4. Modification of any component or part of the product not supplied by the manufacturer or not performed on by the manufacturer or by an authorized distributor.
5. Depreciation or damage caused by normal wear, lack of reasonable and proper maintenance, failure to follow operating instructions, misuse, lack of proper protection during storage, or accident.
6. Normal maintenance and replacement of maintenance wear items, such as oil, filters, chain, bearings, cables, spark plugs and tires.

D. PARTS REPLACED UNDER WARRANTY

Only new or remanufactured parts or components, furnished or approved by the manufacturer, will be used to repair the product.

E. SECURING WARRANTY SERVICE

To obtain performance of this warranty, the original retail purchaser must request warranty service from an authorized distributor. Present evidence that corresponds with the warranty registration card on date of delivery, and inform the distributor in what way the purchaser believes the product to be defective.

F. NO IMPLIED WARRANTY OR OTHER REPRESENTATION

Where permitted by law, neither the manufacturer nor any company affiliated with the manufacturer makes warranties, representations or promises as to the quality, performance or freedom from defect of the product covered by this warranty. **NO IMPLIED WARRANTY OF MERCHANTABILITY OF FITNESS IS MADE.**

G. LIMITATION OF PURCHASER'S REMEDIES

Where permitted by law, the purchaser only remedies in connection with the breach or performance of any warranty on the product, are those set forth on this page. In no event will the distributor, manufacturer or any company affiliated with the manufacturer be liable for incidental or consequential damages, including but not limited to loss of profit, rental of substitute equipment or other commercial loss.

H. NO SUBDISTRIBUTOR OR DISTRIBUTOR WARRANTY

The selling distributor makes no warranty of its own on any item warranted by the manufacturer and makes no warranty on any other item unless it delivers to the purchaser a separate written certificate specifically warranting the item. **THE DISTRIBUTOR HAS NO AUTHORITY TO MAKE ANY REPRESENTATION OR PROMISE ON BEHALF OF THE MANUFACTURER, OR TO MODIFY THE TERMS OR LIMITATIONS OF THIS WARRANTY IN ANY PART.**

CUSTOMER RECORD COPIES TO REMAIN IN MANUAL

WARRANTY REGISTRATION DETAILS (Please print clearly)	
Purchase Date:	_____
Owner:	_____
Address:	_____
City:	_____ State/Prov/Country _____ Code: _____
Model No.:	_____ Serial No.: _____
Engine No.:	_____ Transmission No.: _____
Selling Distributor:	_____
Pre-Delivery Certification:	_____
	(Distributor Signature)
	Customer Copy

SAFETY ACKNOWLEDGEMENT	
I, _____ acknowledge reading all pertinent safety and operational information enclosed and that the distributor has advised me of the locations and the reasons for all safety emblems on the machine. The distributor has also advised me on the safe operating procedures for the greensIRON 6200 . This information will be made available to all other operators of the greensIRON 6200 .	
_____	Date: _____
(Greens Keeper)	
	Customer Copy

SECTION 8 (con't)

DISTRIBUTOR COPY TO BE COMPLETED AND REMOVED AT POINT OF SALE

WARRANTY REGISTRATION DETAILS (Please print clearly)	
Purchase Date:	_____
Owner:	_____
Address:	_____
City:	_____ State/Prov/Country _____ Code: _____
Model No.:	_____ Serial No.: _____
Engine No.:	_____ Transmission No.: _____
Selling Distributor:	_____
Pre-Delivery Certification:	_____
	(Distributor Signature)
	Distributor Copy

WOOD BAY COPY TO BE COMPLETED, REMOVED AND FORWARDED TO:

Wood Bay Turf Technologies
A Division of Wood Bay Consulting Group Limited
202, 8704-51 Avenue
Edmonton, AB T6E 5E8
Fax to: 780-468-0059

Wood Bay Turf Technologies
A Division of Wood Bay Consulting Group Limited
19609 North Welk Drive
Sun City, AZ 85373

WARRANTY REGISTRATION DETAILS (Please print clearly)	
Purchase Date:	_____
Owner:	_____
Address:	_____
City:	_____ State/Prov/Country _____ Code: _____
Model No.:	_____ Serial No.: _____
Engine No.:	_____ Transmission No.: _____
Selling Distributor:	_____
Pre-Delivery Certification:	_____
	(Distributor Signature)
	Wood Bay Copy

SAFETY ACKNOWLEDGEMENT

I, _____ acknowledge reading all pertinent safety and operational information enclosed and that the distributor has advised me of the locations and the reasons for all safety emblems on the machine. The distributor has also advised me on the safe operating procedures for the **greensIRON 6200**. This information will be made available to all other operators of the **greensIRON 6200**.

_____ Date: _____
(Greens Keeper)

Wood Bay Copy



greensIRON 6200

MANUFACTURED BY:



Turf Technologies

FOR LOCAL SALES & SERVICE INFORMATION CALL:

202, 8704 – 51 Ave.
Edmonton, AB
Canada T6E 5E8

Toll Free: 1-800-661-4942

Direct: 1-780-468-4378

E-mail: info@woodbayturftech.com

Web Site: www.woodbayturftech.com