

FDS 9200

TURF DETHATCHER

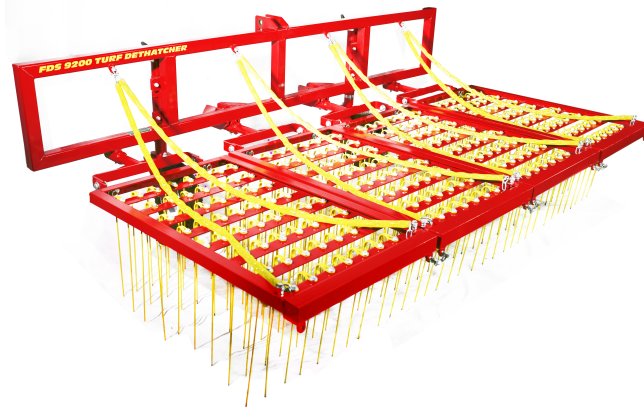

OPERATION, SERVICING & PARTS MANUAL

Serial Number

Engineered and Manufactured Exclusively by

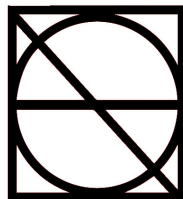

woodbay

TURF TECHNOLOGIES

FDS 9200

TURF DETHATCHER

OWNER AND OPERATORS' MANUAL

1.0 Introduction:

The *fds 9200 Turf Dethatcher* was developed for thatch removal on golf courses and sports fields, but is designed to be used on many different grass or turf areas such as public parks, wide boulevards and sod farms. The unit can be pulled by a tractor with a three-point hitch.

The purpose of the *fds 9200 Turf Dethatcher* is to remove thatch from the root zone before overseeding and to allow for faster air, water and fertilizer penetration. It can also be used as a spreader for turf dressings on established growth, or for topsoil and dressing during course construction and landscaping operations. Wood Bay Turf Technologies is confident that you will find the *fds 9200 Turf Dethatcher* versatile, efficient and economical to use, while promoting much healthier turf.

2.0 Important Safeguards:

When using the *fds 9200 Turf Dethatcher* basic safety precautions must always be followed to avoid damage or injury including:

- 2.1 Ensure that the three point hitch is properly connected before readying the unit for movement and use.
- 2.2 Before lifting or moving the unit, disconnect the parking rods and clip them to the outside platform sections.
- 2.3 Ensure that the bridle chains are all firmly connected.
- 2.4 Ensure that the pressure in the gauge wheel tires is appropriate, as recommended on the sidewall.
- 2.5 Never allow a person to ride on the unit, and ensure that no tools or other loose objects are placed on the platform sections.
- 2.6 Avoid excess speed during dethatching operations. Speeds in excess of 5 mph (8 kph) could cause tines to break, resulting in unnecessary damage.
- 2.7 The unit should be used on dry turf to avoid any tearing.
- 2.8 Before unhitching the unit, ensure it is resting firmly on the ground, and that the parking rods are secured to brace the outside sections.
- 2.9 Check for the location of irrigation heads and other surface objects that could be damaged or cause damage to the *fds 9200 Turf Dethatcher*.

3.0 Assembly and Adjustment:

The *fds 9200 Turf Dethatcher* is assembled and crated for shipping with the hitch frame secured to the pallet, except that the gauge wheel assemblies are packed separately. While unpacking the turf dethatcher, ensure that the platform frames are well supported when they are released from the pallet and placed on the ground.

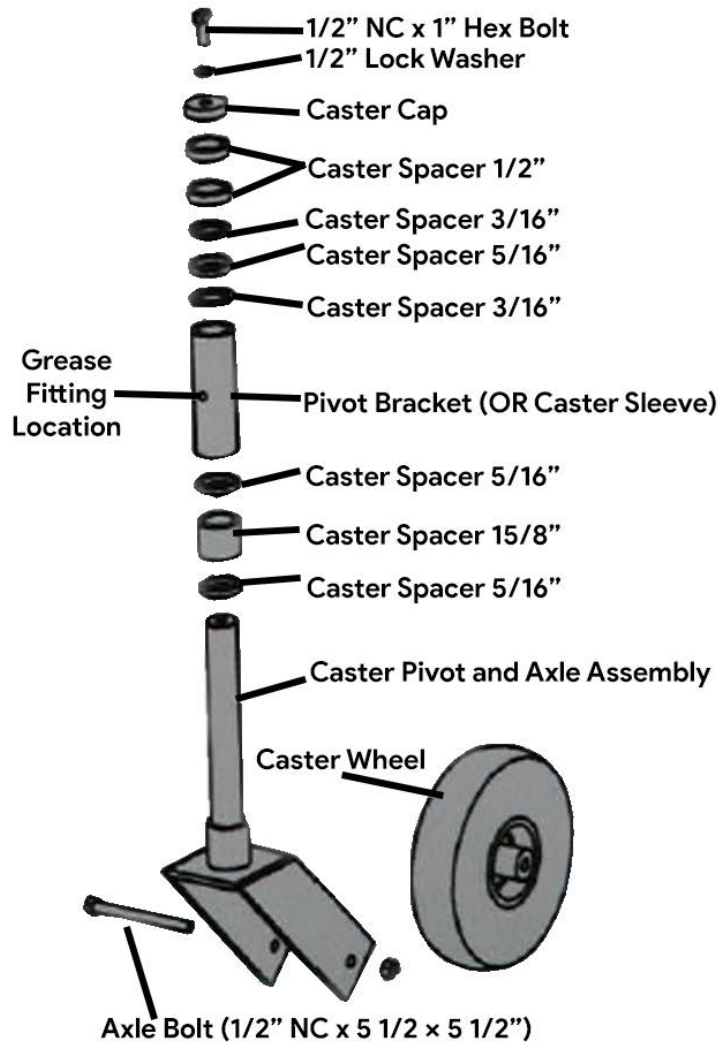

The gauge wheel assembly shafts must be inserted in the swivel brackets at the front of the frame with appropriate spacers above and below the brackets (see figure at left for the parts view). With the unit hitched to the tractor and raised up, place the following spacers on the caster pivot shaft before inserting it in the pivot bracket:

1. Caster Spacer 1 5/8"
2. Caster Spacer 1/2"
3. 2 of Caster Spacer 5/16"
4. Caster Spacer 3/16"

The remaining spacers are to be installed above the pivot bracket. This setting should allow the tines to penetrate about 1/2" into the turf. Then you will need to test the *fds 9200 Turf Dethatcher* on your turf to see if any adjustment in spacer positions is needed.

The proper adjustment can only be determined by trial and error in relation to your turf and soil conditions. While

being pulled over the turf, the tines must penetrate to the desired depth into the thatch layer. If the tines are set too high they will not remove enough thatch.

On the other hand, if the tines are set too low they may cause damage to the turf and won't vibrate enough for proper thatch removal. The depth setting on inch increments by removing the gauge 1/2" to 3/16" each side can be adjusted in wheel and switching a spacer from above to below the swivel bracket, or vice versa. Once this adjustment has been completed, it should only have to be done again at lengthy intervals in relation to wear on the tines from use

The positioning of the gauge wheels when mounted is illustrated below:

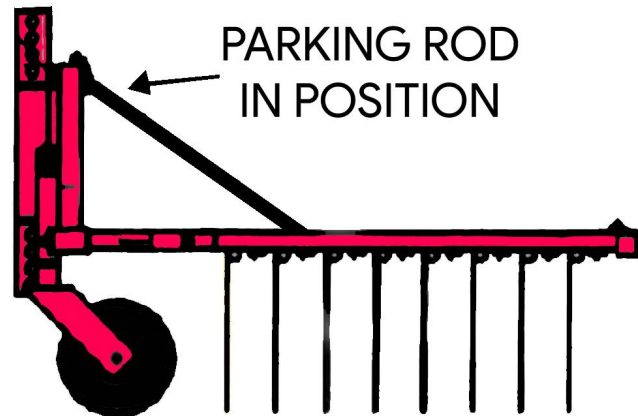

Gauge Wheel Alignment illustration

4.0 Maintenance of Equipment:

Maintenance requirements for the *fds 9200 Turf Dethatcher* are minimal as follows:

4.1 A standard type of equipment grease will need to be applied periodically through each of the grease nipples. These are located on each of the swivel brackets for the gauge wheels, and on the swivel connections for each tine platform section.

4.2 The gauge wheel tires will need to be inspected periodically for wear and for the inflation pressure. Since the tires are tube-type, in the event of a puncture a standard tube patch will be required.

4.3 Under most operating conditions, the tines should not break. However, it can be expected that one or more tines will fail during use, so a safety cable has been threaded through each row of tines on each platform section to prevent any broken tines from falling onto the turf. As soon as it is discovered any broken tine should be replaced by unclipping the safety cable, removing the bolt at the tine connection, installing the new tine and reinserting the safety cable.

4.4 As with any other piece of equipment the *fds 9200 Turf Dethatcher* should be cleaned after use to remove any accumulation of debris and prevent oxidization or other damage to the frame and tines.

5.0 Operations on the Turf:

The pattern of operation during use of the *fds 9200 Turf Dethatcher* should be much the same as that followed for fairway mowers. A tight line pattern can be followed by lifting the unit at the end of each run before making the turn. Normally, only one pass should be needed to loosen sufficient thatch with the *fds 9200 Turf Dethatcher*. However, if a second pass is desired it should be made using a pattern that crosses over the prior one.

In confined areas, or around trees, other planting areas, sand traps, water hazards, cart paths and other irregular features, the *fds 9200 Turf Dethatcher* can be pulled through any turns or irregularities without difficulty.

6.0 Components of the *fds 9200 Turf Dethatcher*:

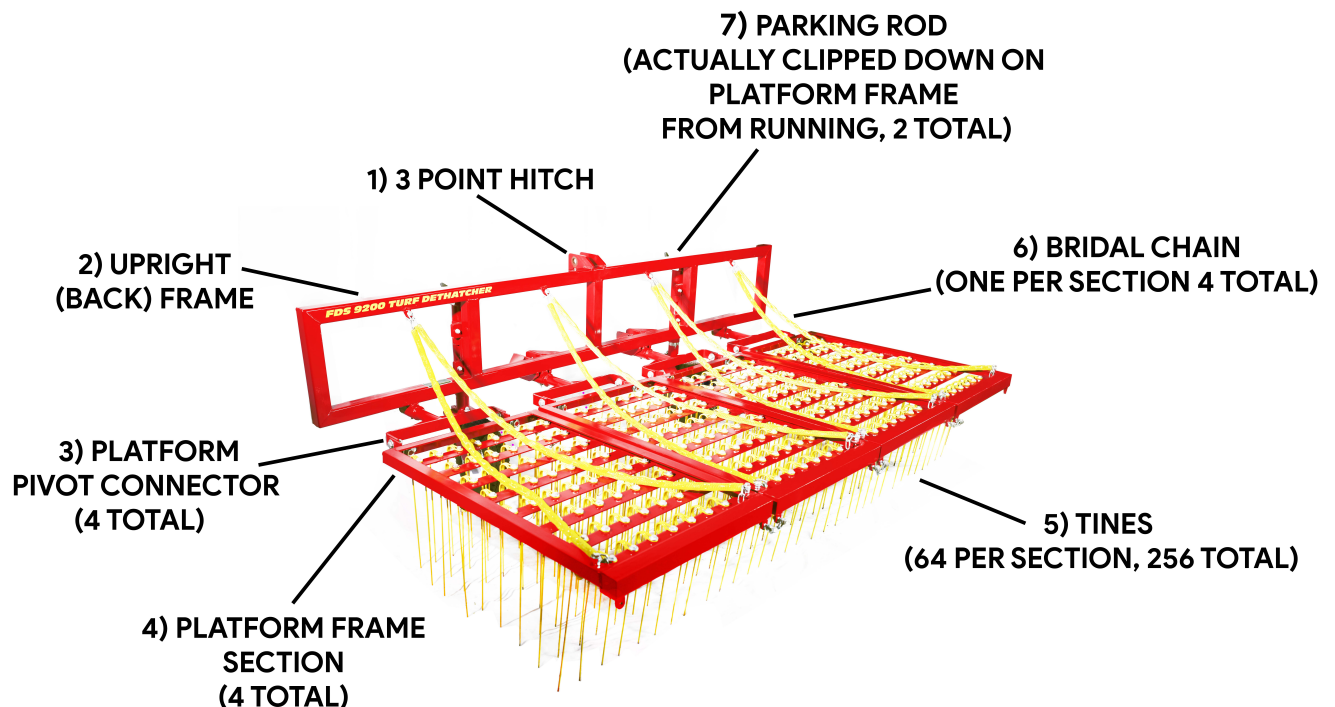

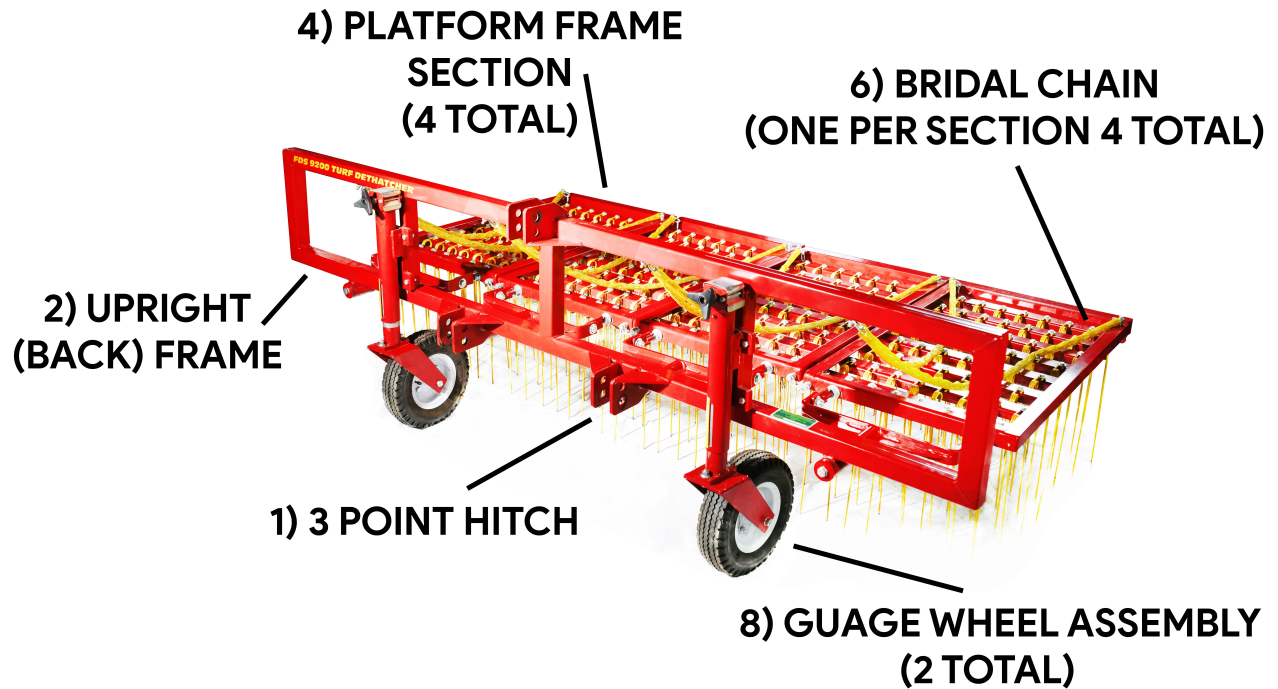

For more information and any service requirements on the *fds9200 Turf Dethatcher* contact your local Wood Bay distributor or Wood Bay Turf Technologies at 780.468.4378: North America T.F. 1-800-661-4942: or e-mail info@woodbayturftech.com.

fds9200 Turf Dethatcher

REPLACEMENT PARTS LIST

Part No.	Description	Quantity
FDS03-280	Hitch and Support (Back) Frame	1
FDS03-281	Assembly Platform Frame Assembly	4
FDS03-282	Platform Pivot Bracket Assembly	4
FDS03-283	Pivot Shaft Cap	4
FDS03-284	Tine (Spring Steel)	256
FDS03-285	Safety Cable with Clips for Tine	32
FDS03-286	Assemblies Parking Rod (Left)	1
FDS03-287	Parking Rod (Right)	1
FDS03-723	Platform Tie Chain	6
FDS03-724	Bridle Chain Leg	4
FDS03-725	Bridal Chain Spreader	4
FDS03-726	Chain Quick Connector	4
FDS03-288	Caster Pivot and Axle Assembly	2
FDS03-661	Caster Wheel (4 ply, nylon, tube type)	2
FDS03-289	Caster Cap	2
FDS03-290	Caster Spacer 3/16"	4
FDS03-291	Caster Spacer 5/16"	6
FDS03-292	Caster Spacer 1/2"	4
FDS03-293	Caster Spacer 1 5/8"	2
FDS03-627	Pin , Hitch Clip (SPAE-NAUR # 090-105)	4

Note: Various standard bolts, nuts and washers are used in assembling the equipment, but are not shown separately on the list. When ordering these standard items, simply refer to them by description (e.g. 3/8" NC x 1 1/2" Hex Bolt).

FDS 9200

TURF DETHATCHER



TURF TECHNOLOGIES

DISTRIBUTED BY:



FOR SALES & SERVICE INFORMATION CALL YOUR
LOCAL WOOD BAY DISTRIBUTOR OR CONTACT WOOD
BAY DIRECT:

#202, 8704 – 51 Ave.
Edmonton, Alberta
Canada T6E 5E8
Ph. 780.468.4378

19609 North Welk Drive
Sun City, Arizona
U.S.A. 85373
Ph. 623.466.7921

North America T.F. 1-800-661-4942
Web Site: www.woodbayturftech.com
E-mail: info@woodbayturftech.com

